



Ladylux



33 790

Kitchen accessories
(optional extras)
see page 6

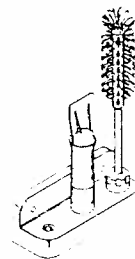

27 831

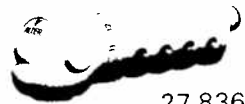

27 836

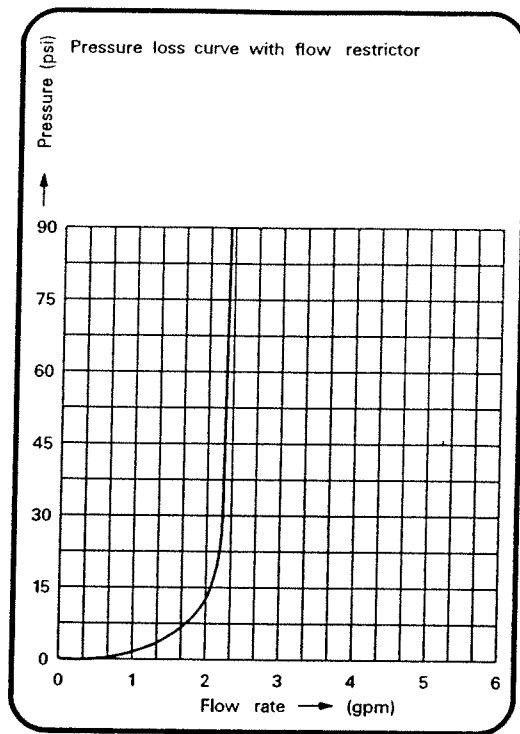

33790

①

Specification

Application

- Pressurized storage heaters
- Thermally controlled instantaneous heaters (set flow temperature to 120 °F.)
- Hydraulically controlled instantaneous heaters

Operation with low pressure storage heaters (displacement water heaters) is **not** possible.

Note: This fitting shall not be recessed more than one-half inch below the flood level of the fixture.

Specification for sink mixer with hand-held spray

- Flow pressure
 - min. 7 p.s.i.
 - recommended 15-75 p.s.i.
 - greater than 75 p.s.i., fit pressure reducing valve
- Working pressure-max. 150 p.s.i.
- Test pressure 230 p.s.i.
- Flow delivery see fig. ①
- Temperature
 - max. (hot water inlet) 160 °F.
 - recommended (economy setting) 140 °F.
- Snap coupling and supply pipes with built-in non-return-valve
- Water connection
 - "Red" mark = LH
 - "Blue" mark = RH
- Clamp length (self thickness) 2-3/8"

Note

Major pressure differences between cold and hot water supply should be avoided.

Replacement parts

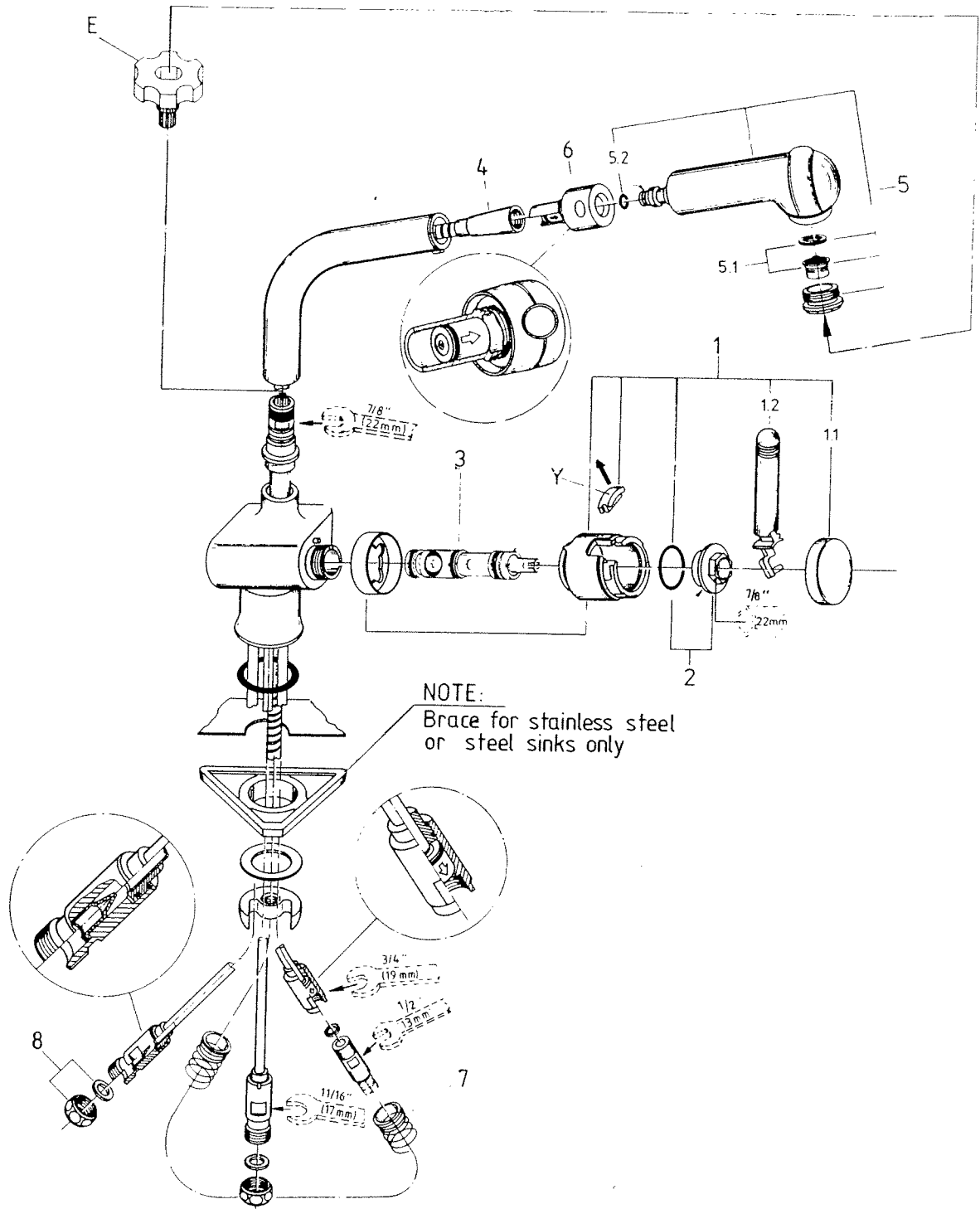

Installation dimensions

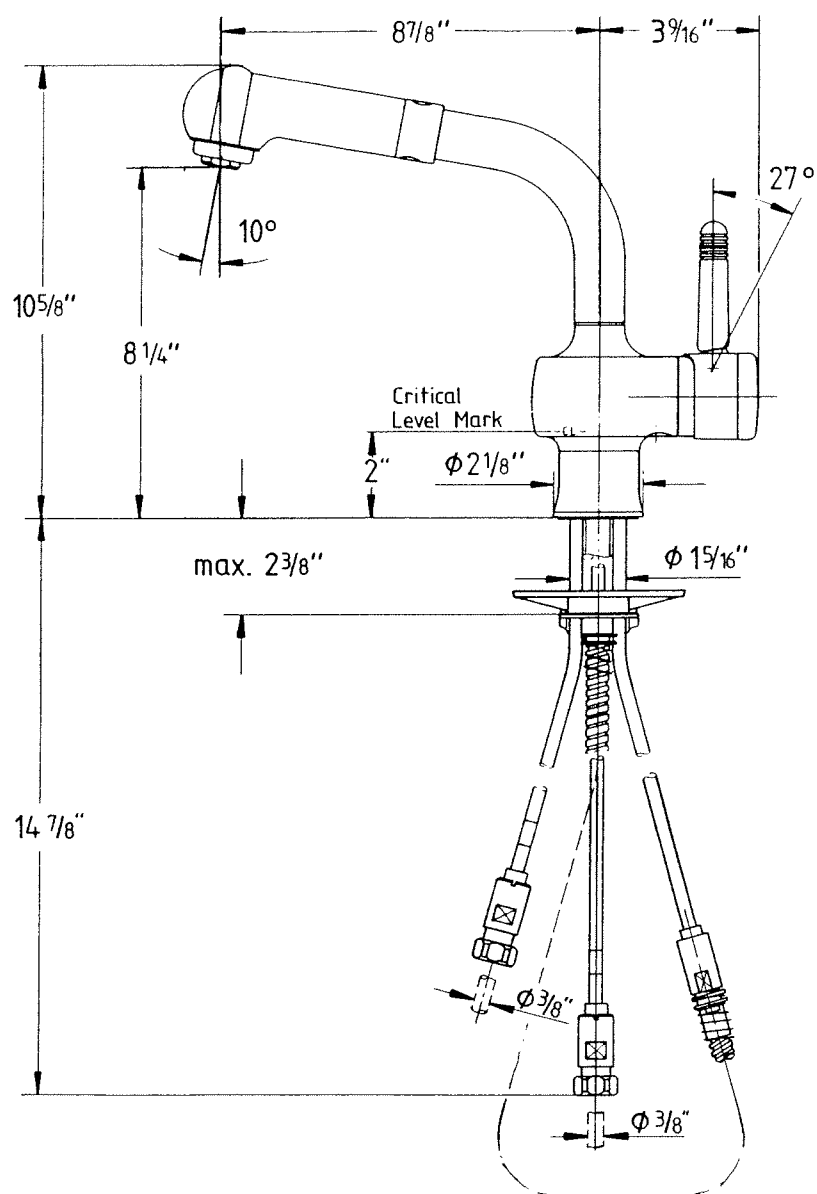

GI
24
BI
60
U.
Te
Pl
Fa

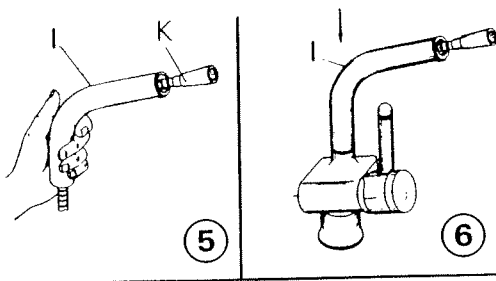

Installation

Connect spray hose (K), see Fig. ⑦

Proceed as follows:

1. Push spray hose (K) through outlet, see fig. ⑤.
2. Insert spray hose (K) from above into body, snap on outlet (I), see Fig. ⑥.
3. Fit spray hose (K), see Fig. ⑦.

Connect handspray (M), see Fig. ⑦

(Do not use any additional seals)

With hand spray fitted, push spring (N) onto spray hose (K) from below.

Fasten spray hose (K) to middle copper pipe, see Fig. ⑦.

Open service valves

Check connections for leakage

Operation, see Fig. ⑧

a) Lever head

- | | |
|-----------------|---------------------|
| Pull lever up | ≙ open (water flow) |
| Push lever down | ≙ closed |
| Swivel lever | |
| - "blue" area | ≙ = Cold water |
| - "red" area | ≙ = Hot water |

b) Handspray

- Pull lever up (mixer open)
The water will always emerge first at the areator.
- | | |
|-------------------------------|---|
| Push changeover control down. | ≙ Changeover to spray jet. |
| Push changeover control up. | ≙ Changeover from spray to areator jet. |

Shutting off the mixer causes automatic changeover from spray to areator jet.

- c) To ensure that the handspray fits correctly when the handspray (M) is inserted, lug (O) on the outlet must engage in recess (P) of the handheld spray.

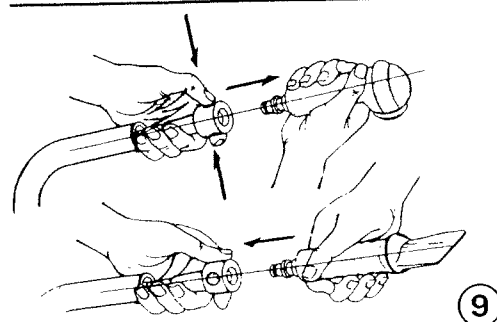
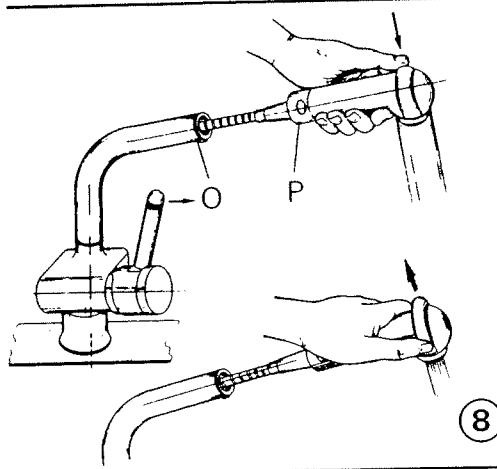
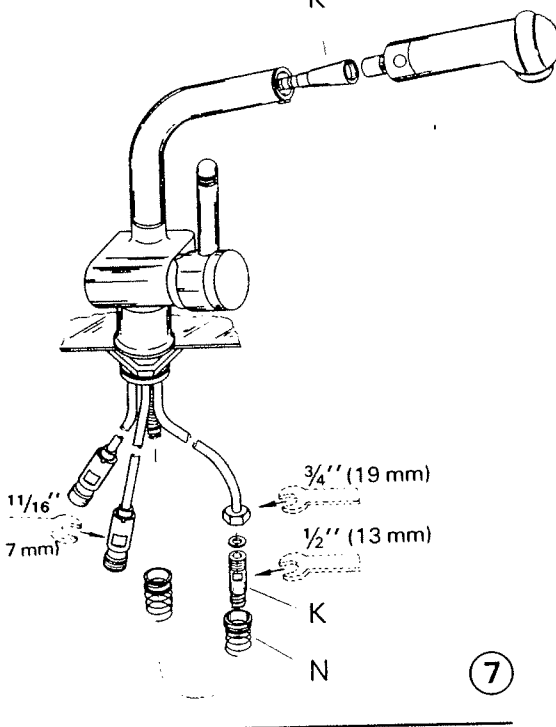

Important see Fig. ⑨

the handspray is fitted with a snap coupling which makes it possible to replace it with items from our kitchen accessory set, see page 5 Special Accessories and page 6. Please note that the mixer must be **turned off** when changing the accessories!

Ensure **positive engagement** of the spray or kitchen accessories in the snap coupling.

Installation

Flush pipes through thoroughly

Prepare sink unit

Drill $1\frac{5}{16}$ " hole for mixer.

See dimensional drawing on fold out page I.

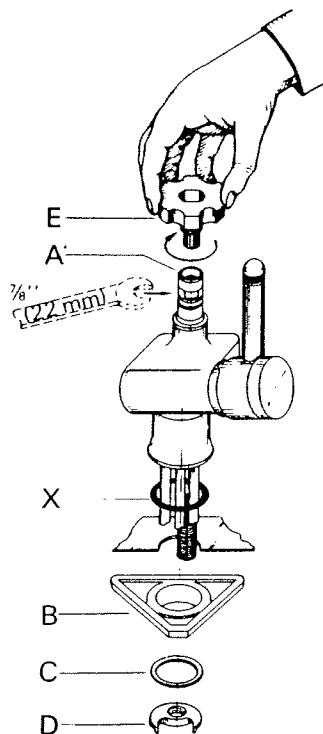

②

Fit mixer, see Fig. ②

Proceed as follows:

1. Fit O-ring supplied (X).
2. Insert mixer in sink unit.
3. Push on reinforcement plate (B) with washer (C) and screw nut (D) on at least one turn by turning fixing tube (A).

Note:

If brace (B) is omitted, clamp length can be increased by $\frac{1}{2}$ " to a total of $2\frac{3}{8}$ ".

4. Determine lever head position, see Fig. ③.
5. Engage wrench (E) in fixing tube (A) and secure mixer by turning assembly wrench clockwise.
(If necessary the fixing tube can also be turned with a $\frac{7}{8}$ " or $\frac{3}{4}$ " A/F open ended spanner).

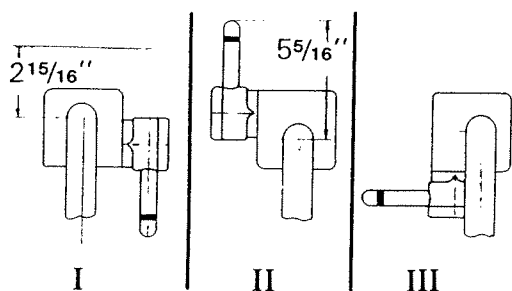

③

Connect mixer

- Hot water connection ("red" mark) = LH
- Cold water connection ("blue" mark) = RH

For reversed connection see Fig. ④.

Reversed connection, see Fig. ④. (hot RH - cold LH)

Remove cover plate (F) by turning clockwise (bayonet catch)

Extract wedge (Y)

Remove lever (G)

Turn control piston (H) through 180°

The water need **not** be shut off for this purpose.

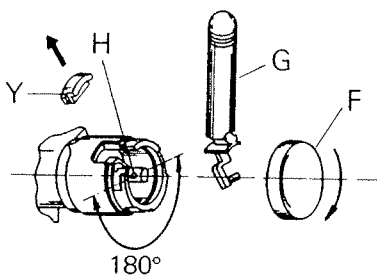

④

Maintenance / care

Maintenance, see fig. ⑩, ⑪ and fold out page II

Shut off hot and cold water supply

1. Remove cover plate (1.1) by turning clockwise (bayonet catch).
2. Extract wedge (Y).
3. Remove lever (1.2).
4. Unscrew headpart (2) by turning counter-clockwise with $\frac{7}{8}$ " A/F open ended spanner and remove with lever holder.
5. Remove cartridge (3) by pulling control piston.
6. Dismantle cartridge as follows, see Fig. ⑩
 - grip clip (R) at the side and extract.
 - Pull control piston (H) out of cartridge sleeve (T).
7. Clean cartridge, check, renew if necessary and lubricate with special fittings grease Cat. No. 18 012. Renew seals if necessary.
Seal set for cartridge Cat. No. 46 090.
8. Unscrew Mousseur and clean strainer (5.1 H).
Use the head of the assembly wrench to unscrew the Mousseur, see fold out page II, item E.

Only original **Grohe** replacement parts may be used.

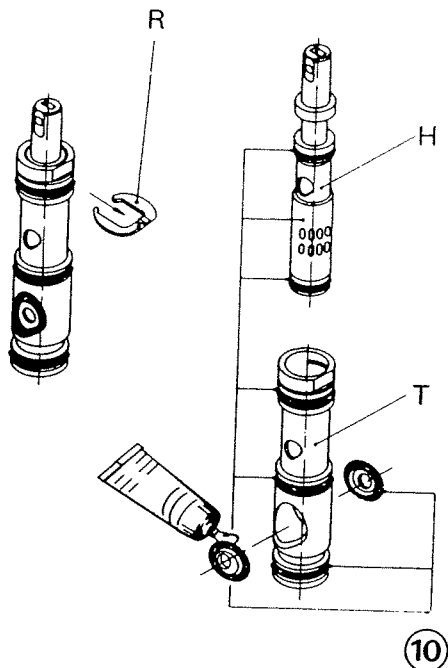

Reassemble in reverse order.

Insert cartridge in housing turning it slightly back and forth.

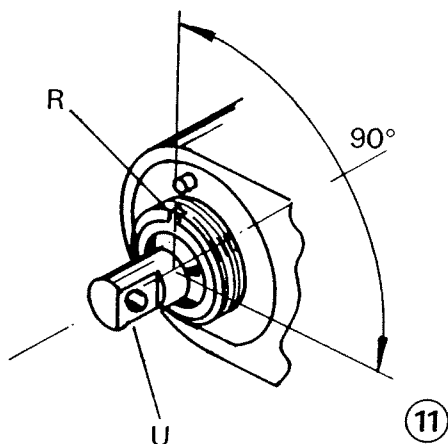

Note:

The tongue of clip (R) **must** engage in the recess on the mixer body (rotation lock), see Fig. ⑪. The flat (U) of the control piston must be on the right, see Fig. ⑪. If the hot/cold function does not agree with the colour symbols on the indicator ring, see "Reversed connection", page 2 Fig. ④.

Care

Instructions for care of this one-hand mixer will be found in the Limited Warranty supplied.

Replacement parts

Specification Page Nos.

Technical Product Information

DRG REF	DRG REF	DRG REF	DRG REF	2-1 DRG REF	DRG REF	Description	Cat. No.	Packing unit
				1	1	Lever head	46 049*	1
				1.1	1.1	Cover plate	46 045*	1
				1.2	1.2	Lever	46 042*	1
				2	2	Headpart with O-ring	46 022	1
				3	3	Euromix cartridge	07 000	1
				4	4	Spray hose assembly 46 092	46 099	1
				5	5	Handheld spray	46 050*	1
				5.1	5.1	Flow regulator set	45 002	1
					5.2	O-ring	01 224	10
					6	Snap coupling with non-return-valve	08 691*	1
					7	Pressure spring	07 240	1
					8	Connection nut set	12 902	2
						Special accessories:		
					-	Kitchen accessory set	27 831	1
					-	Filter spray head	27 836*	1
					-	Touch-up enamel paint	46 076*	1

* This parts are available in colours.
Colour must be specified when ordering.

Subject to technical modifications without notice.